



## Double Inlet Centrifugal Fans With Backward Curved Impeller Blades - Belt Driven Series RDH

- Without integrated motor.
- High performance, robust construction.
- Construction of galvanized sheet steel.
- V-belt and pulley transmission drive.
- Optional mounting inside a **Fan Section**.
- Contained in an “L” shaped support frame.
- Suitable for commercial - industrial applications, kitchens, car parks etc.
- High air flows - low noise level.
- Performance curves available for all types.
- Volume up to **290.000 m<sup>3</sup>/h**.
- Pressure up to **3.500 Pa**.
- Ventilation air temperature up to **+80°C**.

RDH Series					
Type	Power (max) (kW)	RPM	Working Temperature °C	Weight (Kg)	Price
RDH E2 180	2,2	6.800	-20°C / +80°C	7,1	⌘
RDH E4 200	3	6.800	-20°C / +100°C	11,8	⌘
RDH E4 225	4	6.800	-20°C / +100°C	13,6	⌘
RDH E4 250	5,5	5.400	-20°C / +100°C	21,0	⌘
RDH E4 280	7,5	4.700	-20°C / +100°C	28,0	⌘
RDH E4 315	7,5	4.100	-20°C / +100°C	32,0	⌘
RDH E4 355	11	3.800	-20°C / +100°C	46,0	⌘
RDH E4 400	15	3.100	-20°C / +100°C	57,0	⌘
RDH E4 450	15	2.800	-20°C / +100°C	73,0	⌘
RDH E4 500	15	2.350	-20°C / +100°C	90,0	⌘
RDH E4 560	18,5	2.100	-20°C / +100°C	141,0	⌘
RDH K 630	18,5	1.700	-20°C / +100°C	173,0	⌘
RDH K 710	22	1.500	-20°C / +100°C	220,0	⌘
RDH K 800	22	1.200	-20°C / +100°C	270,0	⌘
RDH K 900	30	1.100	-20°C / +100°C	343,0	⌘
RDH K 1000	37	1.000	-20°C / +100°C	415,0	⌘



**RDH E2-0180** 7.1 kg

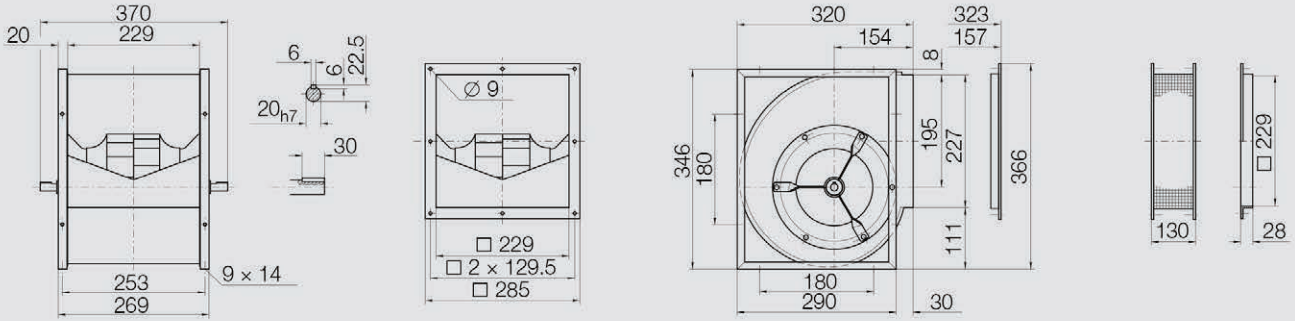

**RDH E4-0200** 11.8 kg

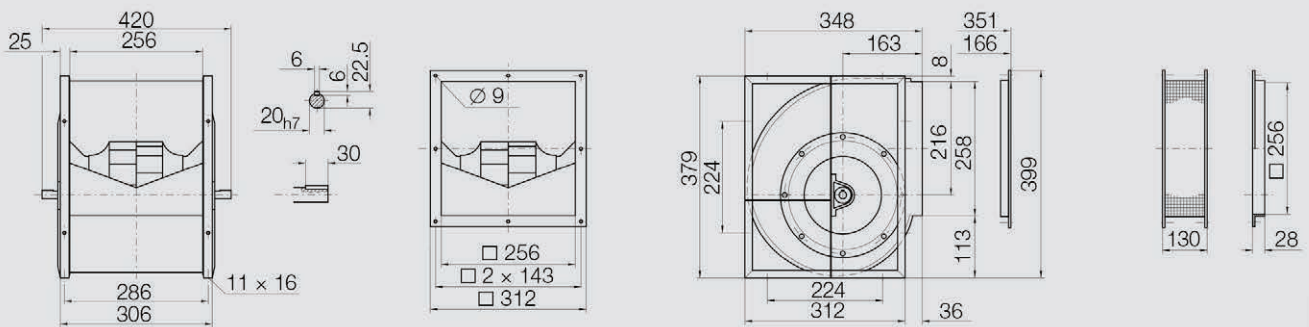

**RDH E4-0225** 13.6 kg

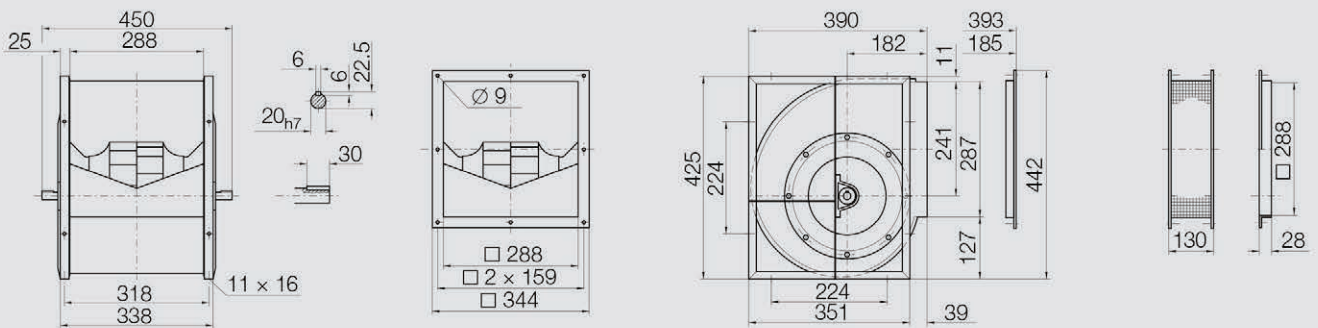

**RDH E4-0250** 21 kg

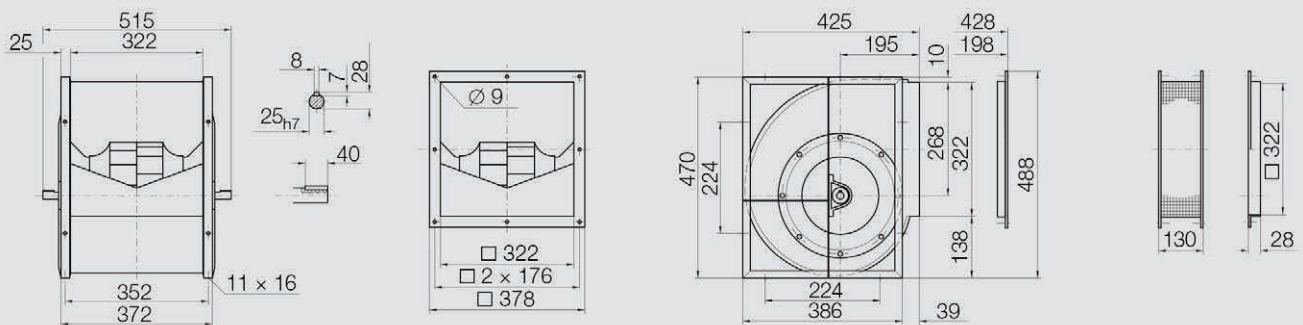

**RDH E4-0280** 28 kg

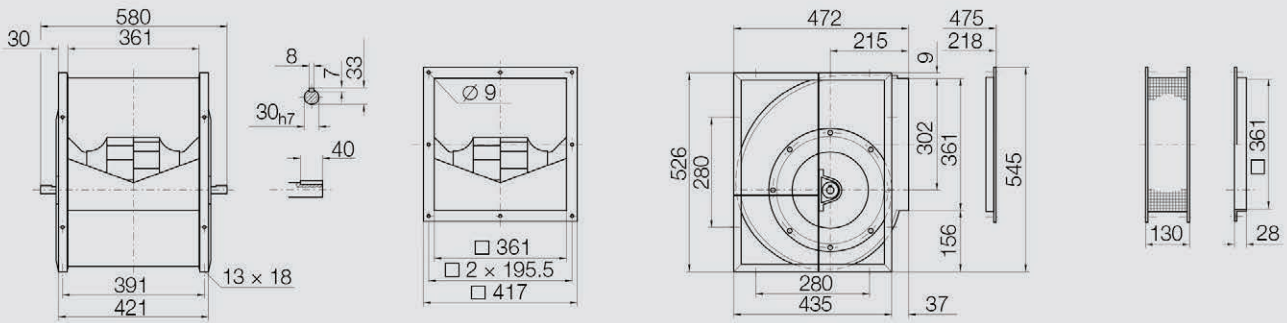

**RDH E4-0315** 32 kg

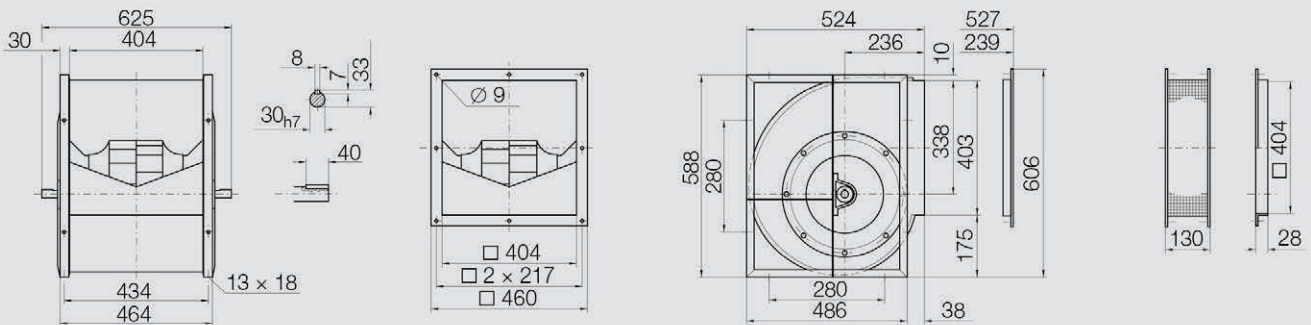

**RDH E4-0355** 46 kg

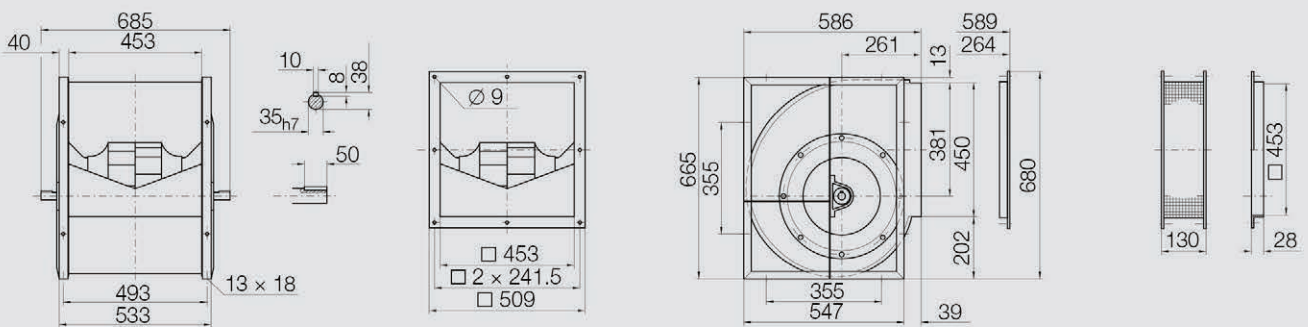

**RDH E4-0400** 57 kg

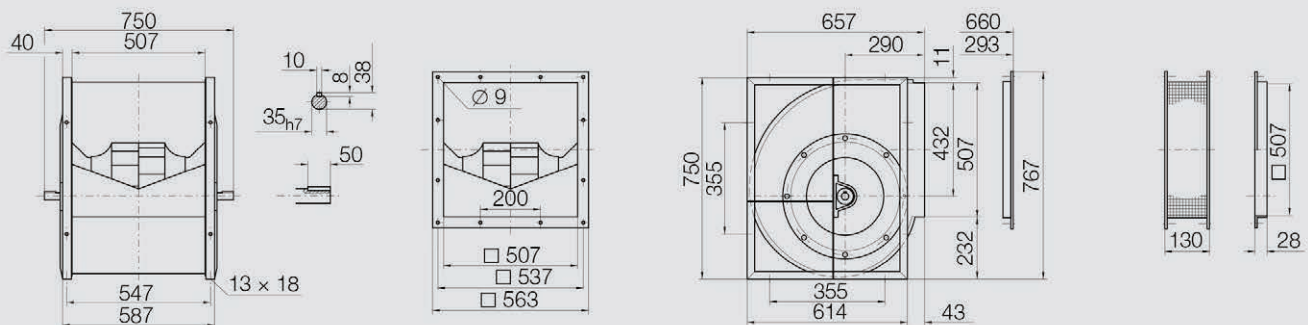

**RDH E4-0450** 73 kg

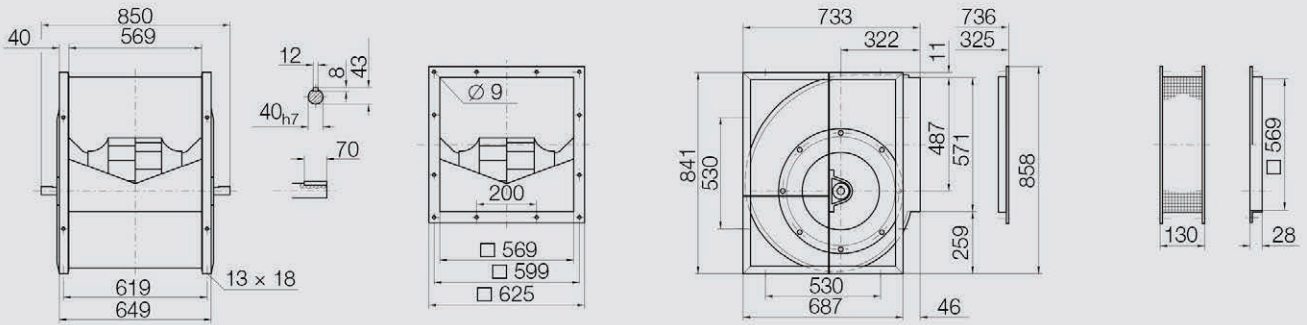

**RDH E4-0500** 90 kg

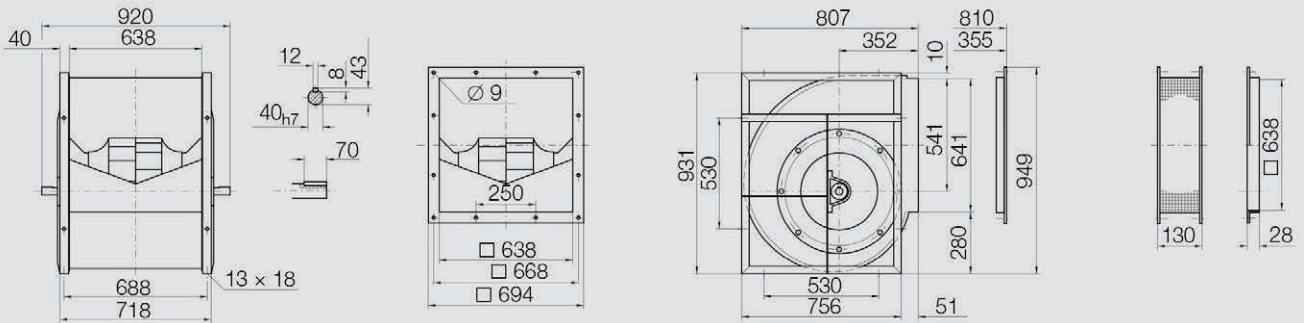

**RDH E4-0560** 141 kg

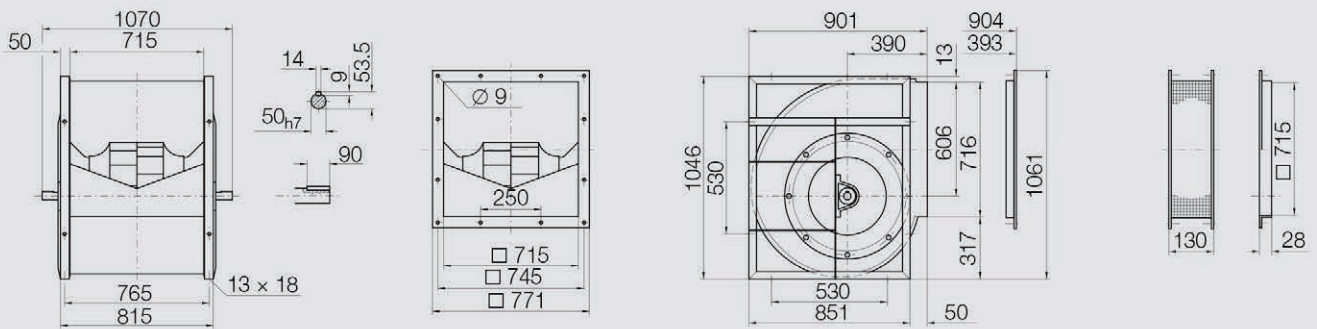

**RDH K-0630** 173 kg

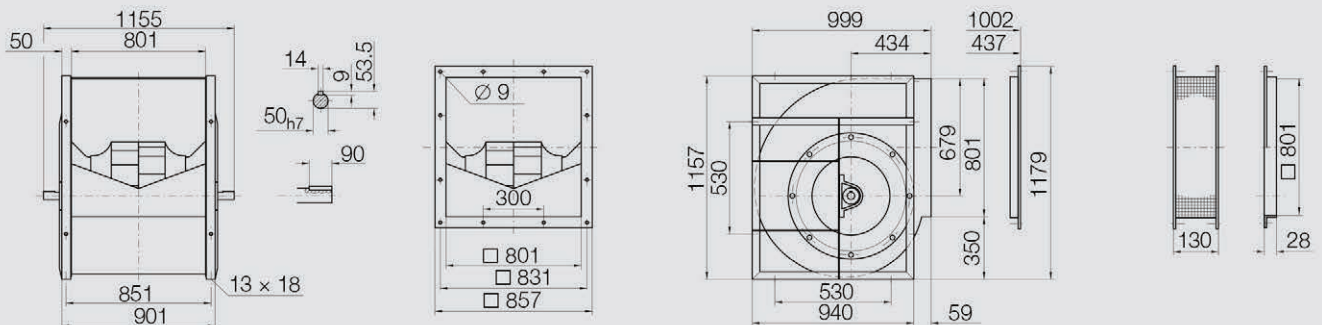

**RDH K-0710** 220 kg

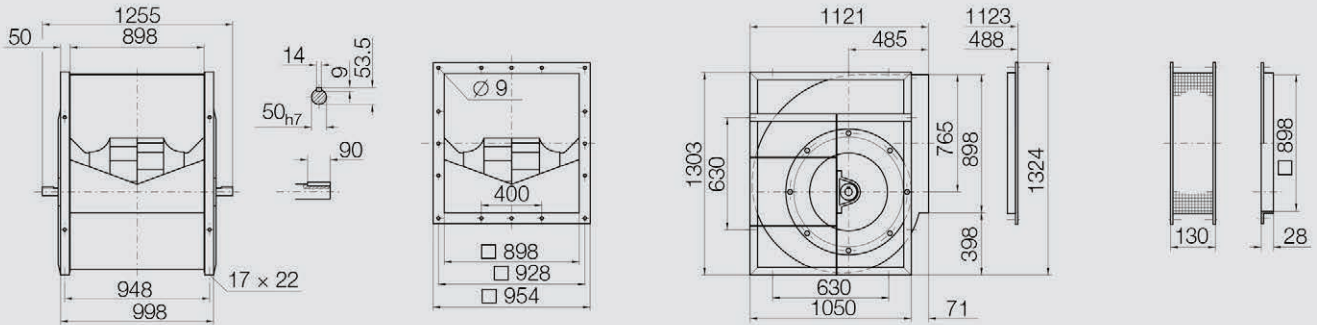

**RDH K-0800** 270 kg

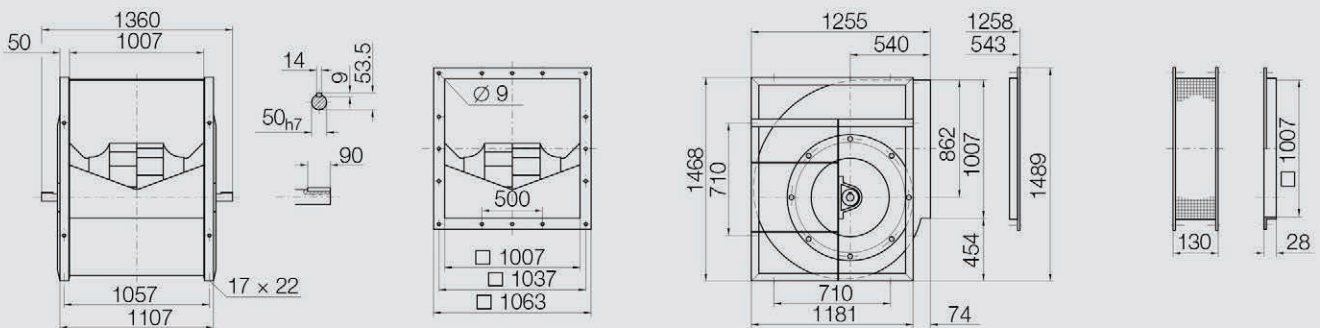

**RDH K-0900** 343 kg

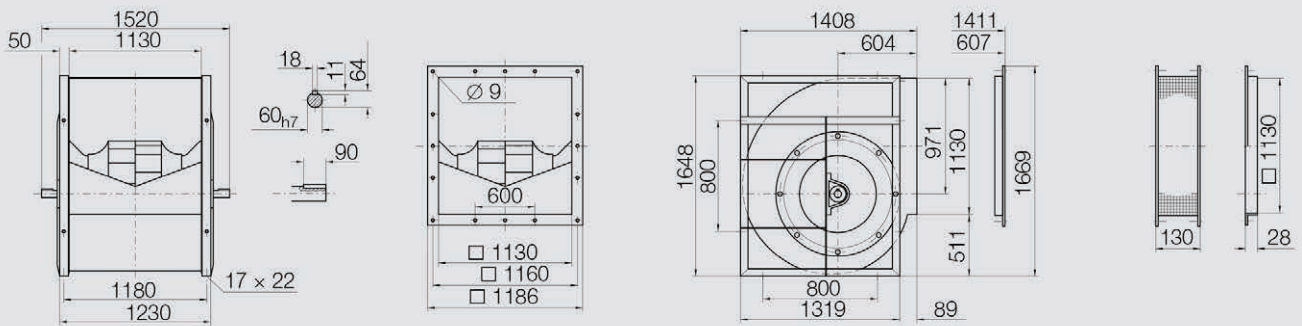

**RDH K-1000** 415 kg

