

900 RPM & 1400 RPM 3 Speed Double Inlet centrifugal Fans (Direct Drive) DD Series

- Direct driven centrifugal fans of DD range with forward curved impeller directly mounted on the shaft of the internal rotor motor are the ideal solution for your applications in the HVAC business.
- This kind of fans are specially conceived for use in dust-free environments, at temperatures up to +40°C, or higher on selected models.
- Internal rotor motor with intergrated thermal protector.
- Fan models suitable for 60 Hz supply are available.

Under request: fan mounting inside a Fan Section (F/S).
 Optionally any special construction in F/S such as: Inlet necks, rain protection outlet grid etc.
 Additional improved double walled insulation etc.

Technical Characteristics DD 900 RPM / 230V 3 Speed							
Type	Power (W)	Air Flow (m³/h)			Fan Price*	Fan Section Dimensions F/S (cm)	Price Asembled F/S
		1η speed	2η speed	3η speed			
DD 9/9 245	245	1.550	2.200	2.850	€ 279,00	60 x 60 x 60	€ 477,00
DD 10/8 245	245	1.450	2.100	2.600	€ 296,00	60 x 60 x 60	€ 495,00
DD 10/10 245	245	1.500	2.200	2.900	€ 301,00	60 x 60 x 60	€ 500,00
DD 10/10 500	500	2.850	3.700	4.620	⌘	60 x 60 x 60	⌘
DD 12/12 736	736	3.900	5.000	5.800	€ 479,00	70 x 70 x 70	€ 714,00

Technical Characteristics DD 900 RPM / 400V 3 Speed							
Type	Power (W)	Air Flow (m³/h)			Fan Price*	Fan Section Dimensions F/S (cm)	Price Asembled F/S
		1η speed	2η speed	3η speed			
DD 7/7 147	147	850	1.150	1.600	€ 234,00	50 x 50 x 50	€ 405,00
DD 9/9 420	420	1.230	1.700	2.900	⌘	60 x 60 x 60	⌘
DD 10/10 550	550	2.100	2.600	2.950	€ 314,00	60 x 60 x 60	€ 512,00

Accessories



3 Speed Switch



Protection Net



Sound Barriers for Rectangular Duct Systems

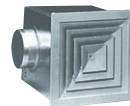

Ventilation & Air Conditioning Plenums



Vents



Air Filters



Axial Fan Heaters With Electric Coils



Hot Water Coils



Tubular Air Electric Coils With Fins



Wall Mounting Set



Air Ducts



Connection Necks

Double Inlet Centrifugal Fans

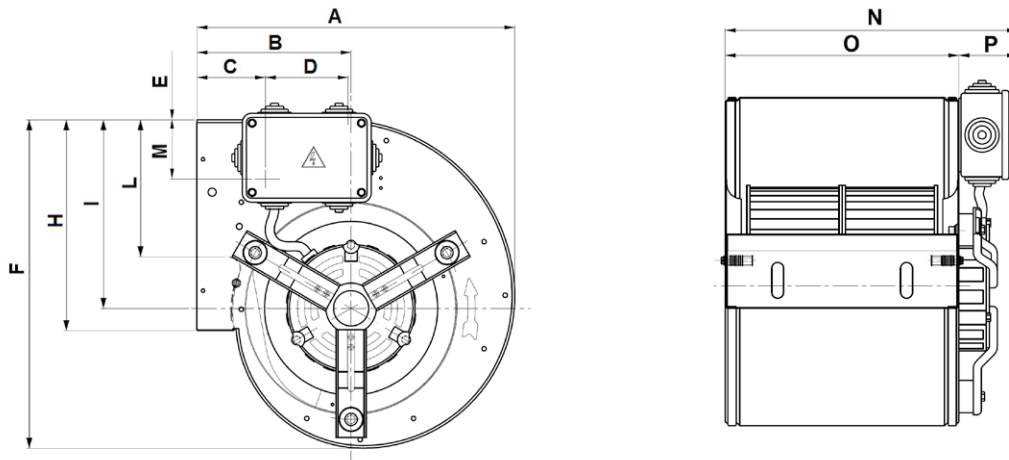

Dimensions DD Series 900 RPM 3 Speed (mm)

Type	A	B	C	D	E	F	H	I	L	M	N	O	P
DD 9/9 245	378,5	185	127	82	29,5	387	262,6	215,5	159,6	71,5	366	232	56
DD 10/8 245	424,5	203	153	82	34,5	443	289,6	249,5	178,6	76,5	311	265	58
DD 10/10 245	424,5	203	153	82	34,5	443	289,6	249,5	178,6	76,5	389	331	58
DD 10/10 500	424,5	203	153	82	34,5	443	289,6	249,5	178,6	76,5	407	331	76
DD 12/12 736	490,5	230	-	-	-	521	342	294,5	214	-	485	395	90

Dimensions DD Series 1400 RPM 3 Speed (mm)

Type	A	B	C	D	E	F	H	I	L	M	N	O	P
DD 7/7 147	315,5	153	68	82	16,5	325	208,6	186,5	135,6	58,5	288	232	58
DD 9/9 420	378,5	185	127	82	29,5	387	262,6	215,5	159,6	71,5	366	298	68
DD 10/10 550	424,5	203	153	82	34,5	443	289,6	249,5	178,6	76,5	405	331	74



DD 7/7 147 4P-1V

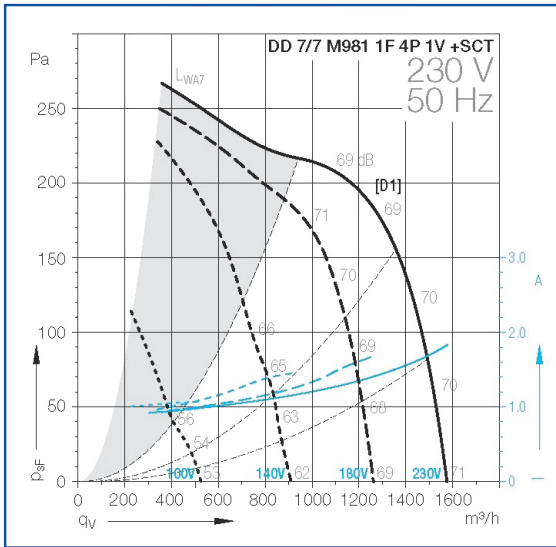

DD 9/7 373 4P-1V

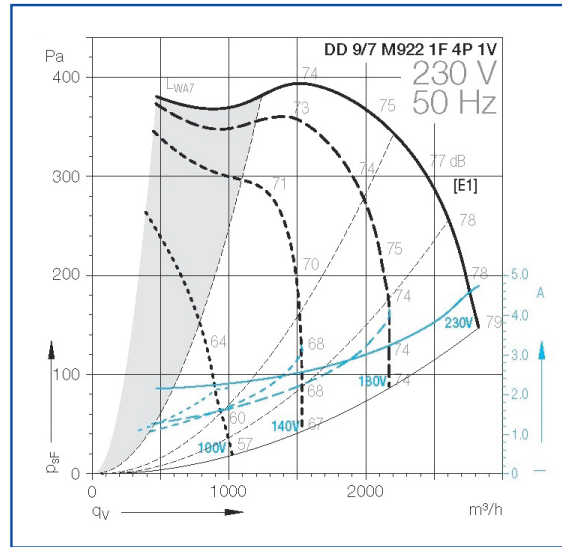

DD 9/9 373 4P-1V

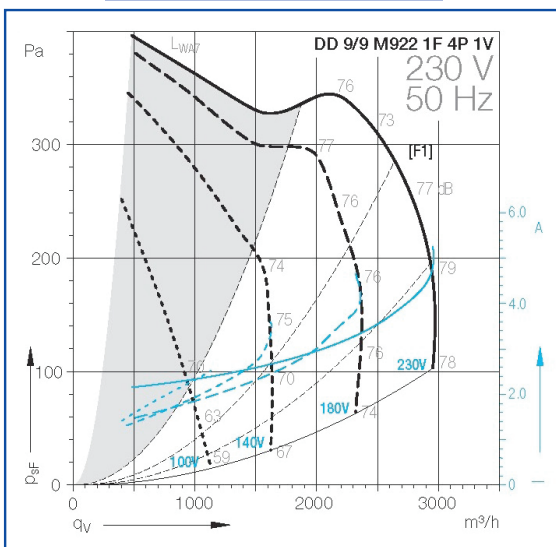

DD 10/10 550 4P-1V

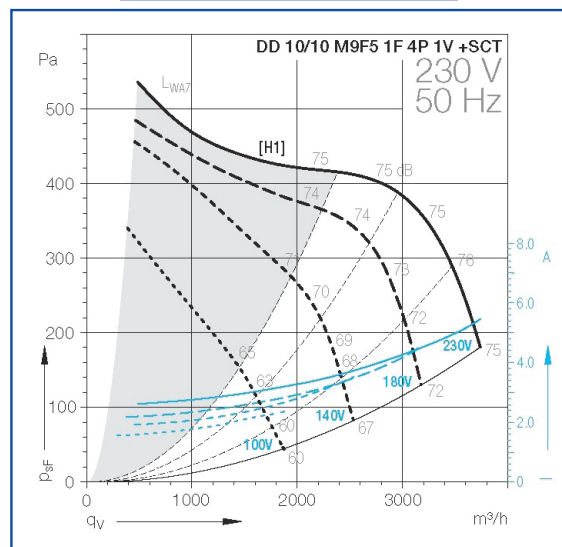

DD 9/9 245 6P-3V

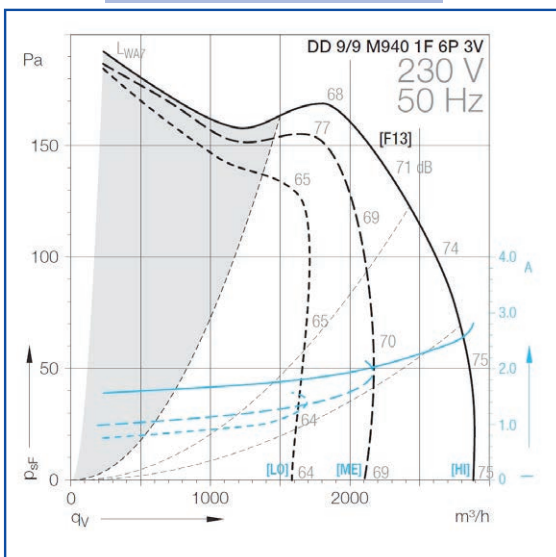

DD 10/8 245 6P-3V

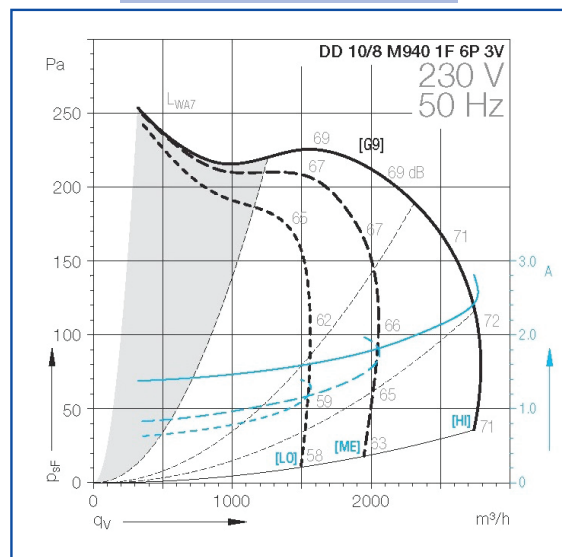

Double Inlet Centrifugal Fans



DD 10/10 245 6P-3V

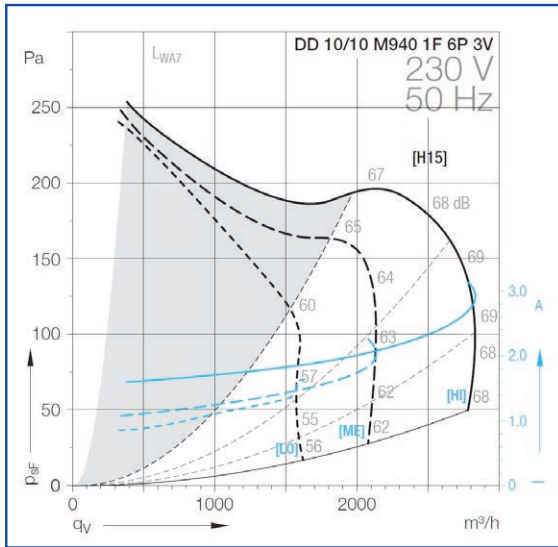

DD 10/10 500 6P-3V

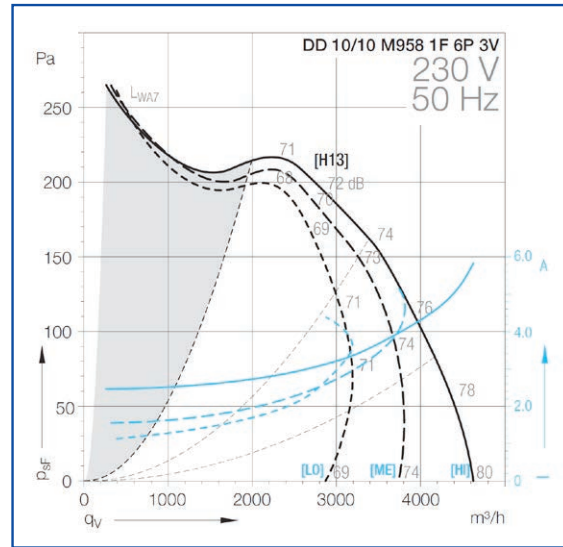

DD 12/12 736 6P-3V

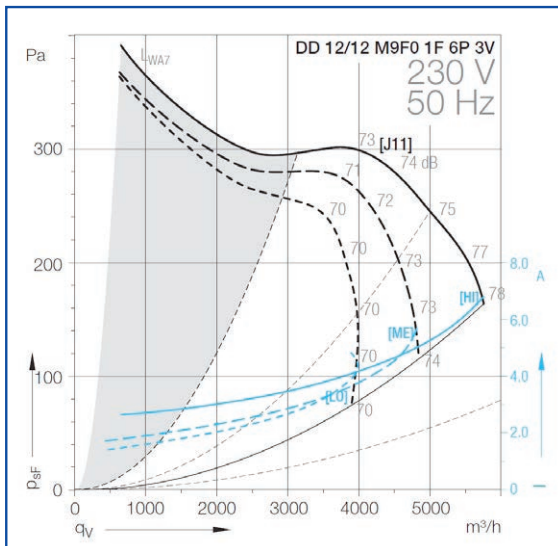

DD 7/7 147 4P-3V

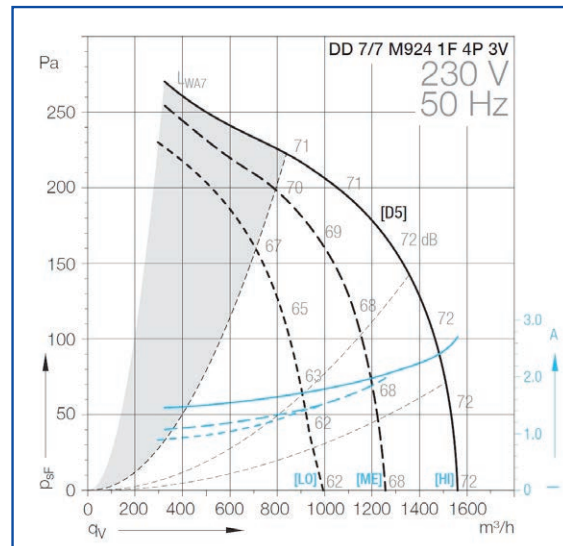

DD 9/9 420 4P-3V

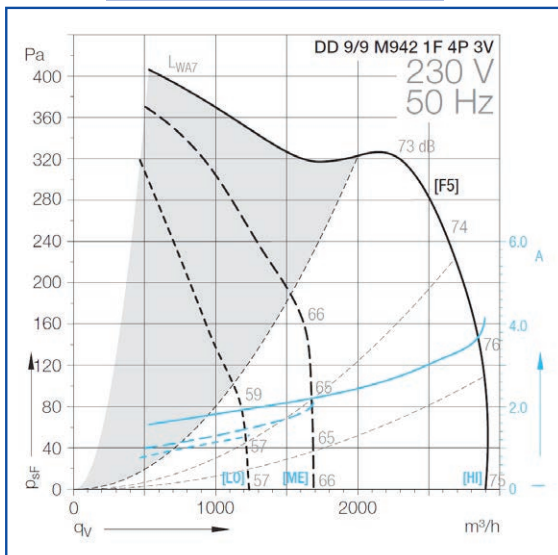

DD 10/10 550 4P-3V

