

900 RPM & 1400 RPM 1 Speed Double Inlet centrifugal Fans (Direct Drive) DD Series

- Direct driven centrifugal fans of DD range with forward curved impeller directly mounted on the shaft of the internal rotor motor are the ideal solution for your applications in the HVAC business.
- This kind of fans are specially conceived for use in dust-free environments, at temperatures up to +40°C, or higher on selected models.
- Internal rotor motor with intergrated thermal protector.
- Fan models suitable for 60 Hz supply are available.

Caution: 380V (three phase) motors should be protected by thermal contacts.

Under request: fan mounting inside a Fan Section (F/S).
Optionally any special construction in F/S such as: Inlet necks, rain protection outlet grid etc.
Additional improved double walled insulation etc.

Technical Characteristics DD 900 RPM / 230V 1 Speed					
Type	Power (W)	Air Flow (m³/h)	Fan Price*	Fan Section Dimensions F/S (cm)	Price Assembled F/S
DD 7/7 147	147	1.550	€ 218,00	50 x 50 x 50	€ 390,00
DD 9/7 147	147	1.950	€ 239,00	60 x 60 x 60	€ 437,00
DD 9/7 245	245	2.800	€ 241,00	60 x 60 x 60	€ 439,00
DD 9/9 147	147	2.000	€ 245,00	60 x 60 x 60	€ 443,00
DD 9/9 245	245	2.700	€ 258,00	60 x 60 x 60	€ 457,00
DD 10/8 245	245	2.650	€ 283,00	60 x 60 x 60	€ 481,00
DD 10/10 245	245	2.900	€ 288,00	60 x 60 x 60	€ 487,00
DD 12/12 590	590	5.500	€ 453,00	70 x 70 x 70	€ 688,00
DD 12/12 736	736	6.000	€ 474,00	70 x 70 x 70	€ 705,00
DD 12/12 1100	1100	8.000	€ 472,00	70 x 70 x 70	€ 706,00

Technical Characteristics DD 900 RPM / 400V 1 Speed					
Type	Power (W)	Air Flow (m³/h)	Fan Price*	Fan Section Dimensions F/S (cm)	Price Assembled F/S
DD 12/9 1100	1100	7.000	€ 432,00	60 x 60 x 60	€ 664,00
DD 12/12 1100	1100	8.000	€ 436,00	70 x 70 x 70	€ 670,00
DD 15/15 1100	2200	12.500	€ 797,00	80 x 80 x 80	€ 1.010,00

Technical Characteristics DD 1450 RPM / 230V 1 Speed					
Type	Power (W)	Air Flow (m³/h)	Fan Price*	Fan Section Dimensions F/S (cm)	Price Assembled F/S
DD 7/7 147	147	1.550	€ 218,00	50 x 50 x 50	€ 390,00
DD 9/7 373	373	2.600	€ 258,00	60 x 60 x 60	€ 457,00
DD 9/9 373	373	2.850	€ 298,00	60 x 60 x 60	€ 497,00
DD 10/10 550	550	3.800	€ 305,00	60 x 60 x 60	€ 505,00

* Fan Mounting Base Included

Accessories



AK 50 Speed controller



Protection Net



Sound Barriers for Rectangular Duct Systems

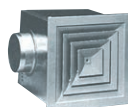

Ventilation & Air Conditioning Plenums



Vents



Air Filters

Double Inlet Centrifugal Fans

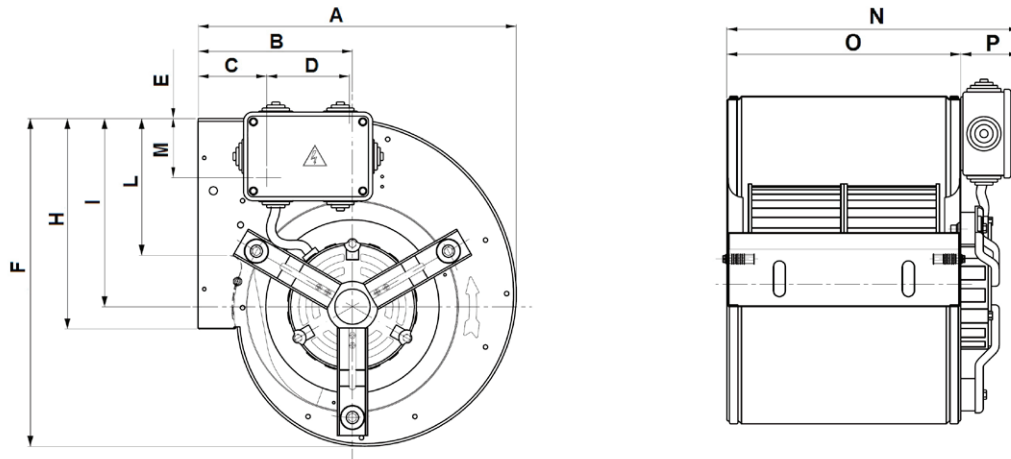

Dimensions DD Series 900 RPM 1 Speed

Type	A	B	C	D	E	F	H	I	L	M	N	O	P
DD 7/7 147	315,5	153	68	82	16,5	325	208,6	186,5	135,6	58,5	290	232	58
DD 9/7 147	378,5	185	127	82	29,5	387	262,6	215,5	159,6	71,5	279	232	47
DD 9/7 245	378,5	185	127	82	29,5	387	262,6	215,5	159,6	71,5	288	232	56
DD 9/9 147	378,5	185	127	82	29,5	387	262,6	215,5	159,6	71,5	345	298	47
DD 9/9 245	378,5	185	127	82	29,5	387	262,6	215,5	159,6	71,5	354	298	56
DD 10/8 245	424,5	203	153	82	34,5	443	289,6	249,5	178,6	76,5	311	265	58
DD 10/10 245	424,5	203	153	82	34,5	443	289,6	249,5	178,6	76,5	389	331	58
DD 12/9 1100	490,5	230	-	-	-	521	342	294,5	214	-	399	309	90
DD 12/12 590	490,5	230	-	-	-	521	342	294,5	214	-	485	395	90
DD 12/12 736	490,5	230	-	-	-	521	342	294,5	214	-	485	395	90
DD 12/12 1100 230V	490,5	230	-	-	-	521	342	294,5	214	-	485	395	48
DD 12/12 1100 400V	490,5	230	-	-	-	521	342	294,5	214	-	485	395	90

Dimensions DD Series 1400 RPM 1 Speed

Type	A	B	C	D	E	F	H	I	L	M	N	O	P
DD 7/7 147	315,5	153	68	82	16,5	325	208,6	186,5	135,6	58,5	288	232	56
DD 9/7 373	378,5	185	127	82	29,5	387	262,6	215,5	159,6	71,5	300	232	68
DD 9/9 373	378,5	185	127	82	29,5	387	262,6	215,5	159,6	71,5	366	298	68
DD 10/10 550	424,5	203	153	82	34,5	443	289,6	249,5	178,6	76,5	405	331	74

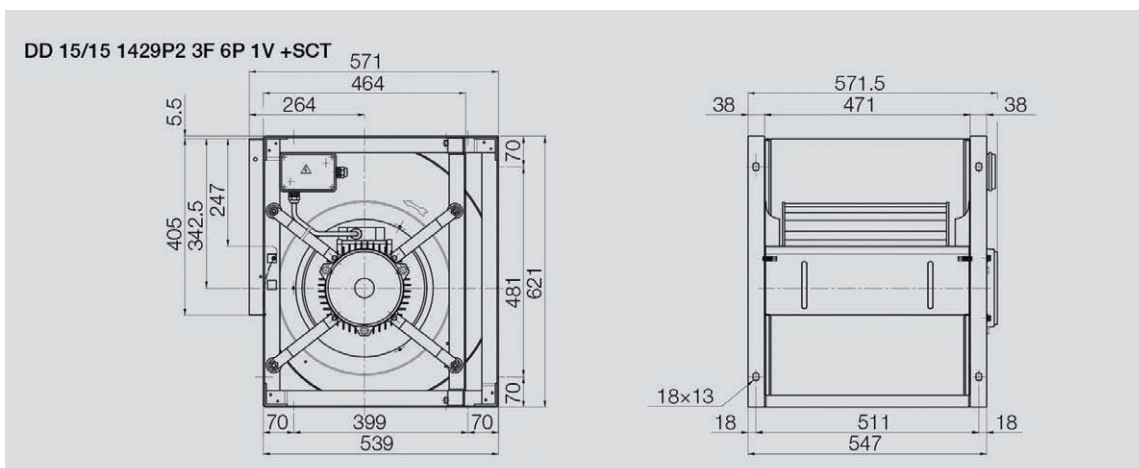

DD 7/7 147 6P-1V

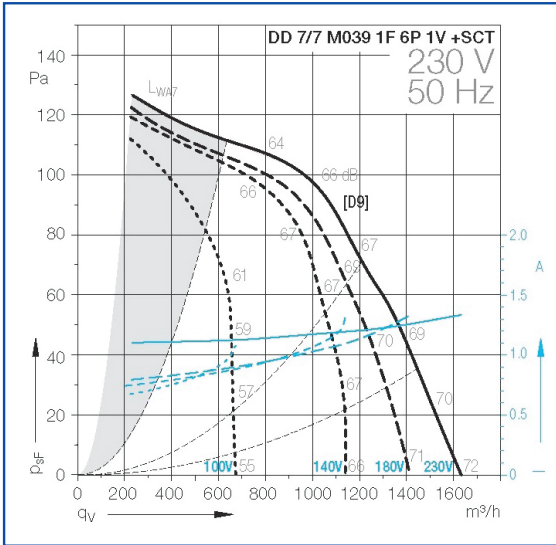

DD 9/7 147 6P-1V

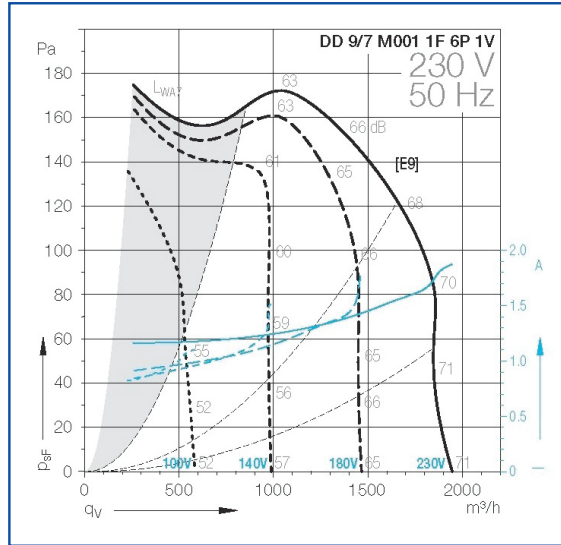

DD 9/7 245 6P-1V

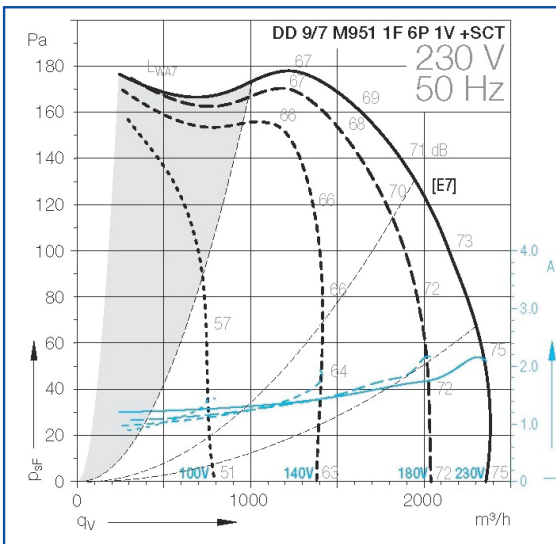

DD 9/9 147 6P-1V

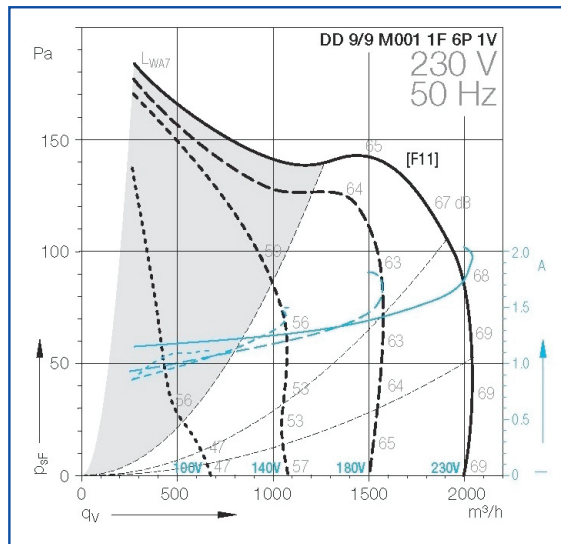

DD 9/9 245 6-1V

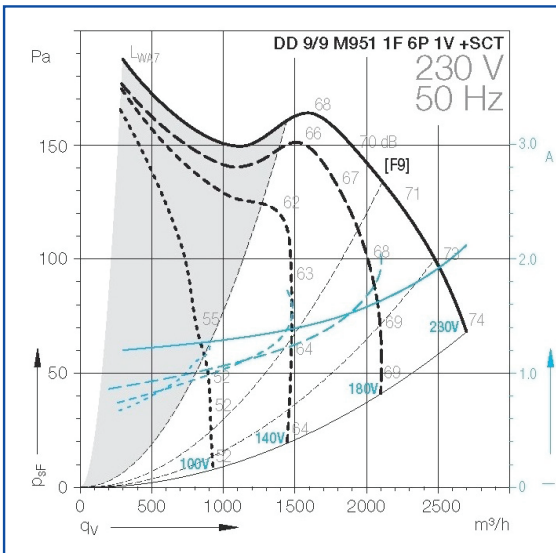

DD 10/8 245 6P-1V

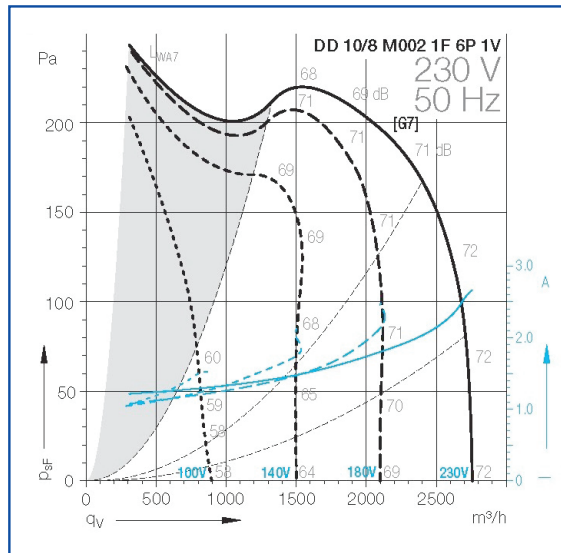

Double Inlet Centrifugal Fans



DD 10/10 245 6P-1V

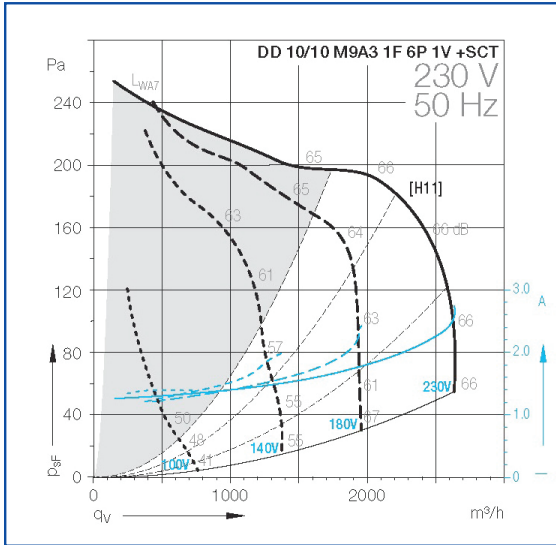

DD 12/9 1.100 6P-1V

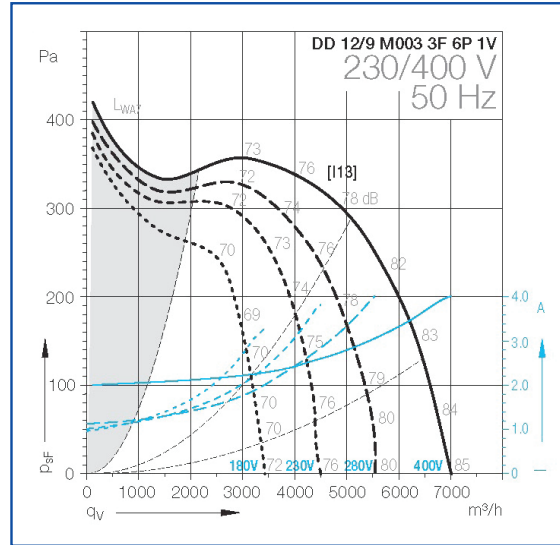

DD 12/12 590 6P-1V

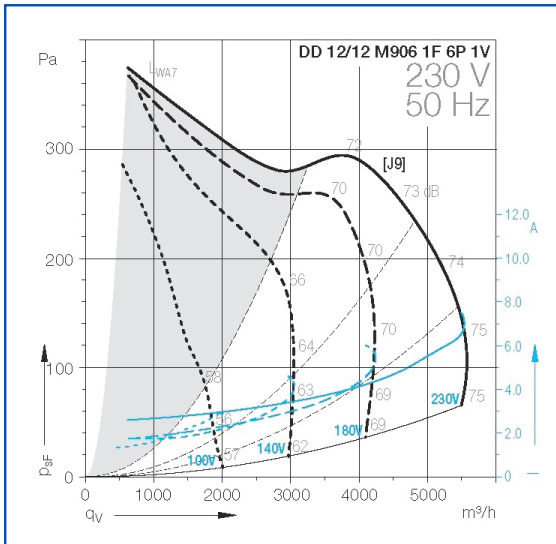

DD 12/12 736 6P-1V

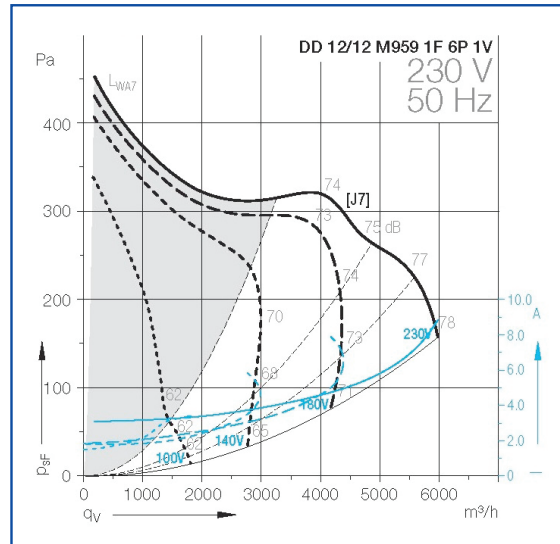

DD 12/12 1.100 6P-1V/400V

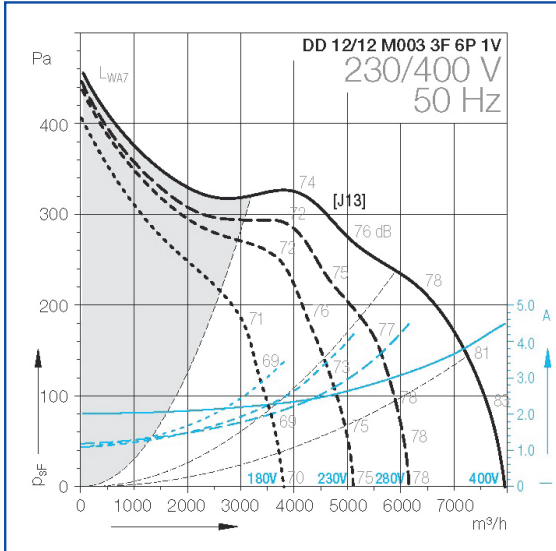

DD 15/15 2.200 6P-1V/400V

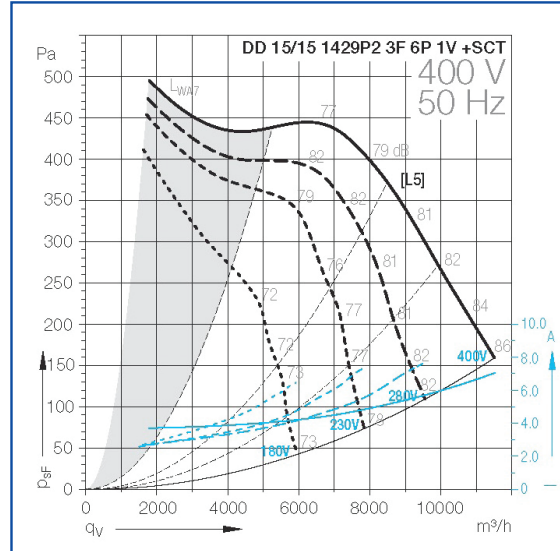

DD 7/7 147 4P-1V

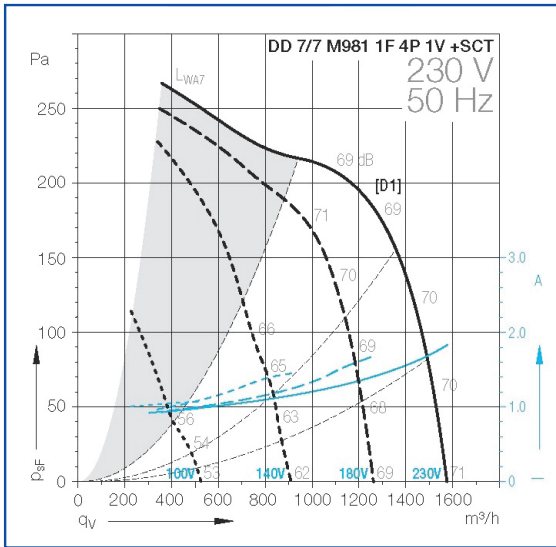

DD 9/7 373 4P-1V

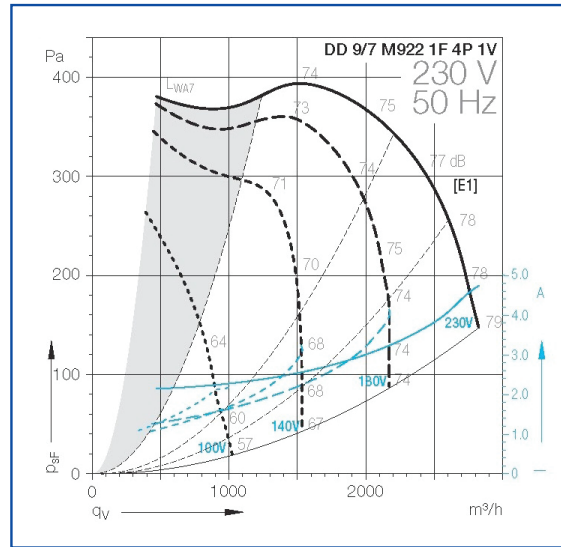

DD 9/9 373 4P-1V

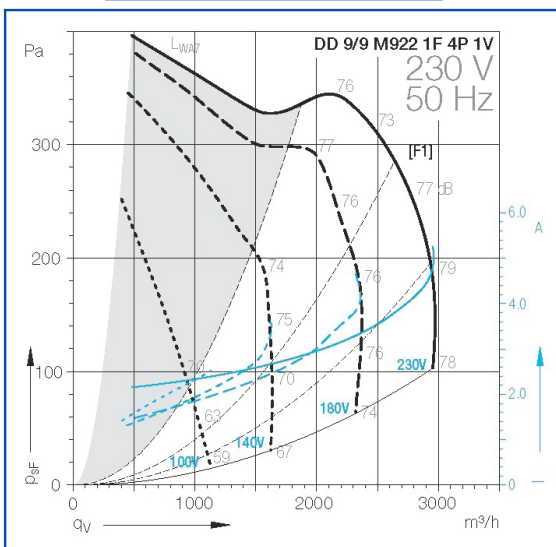

DD 10/10 550 4P-1V

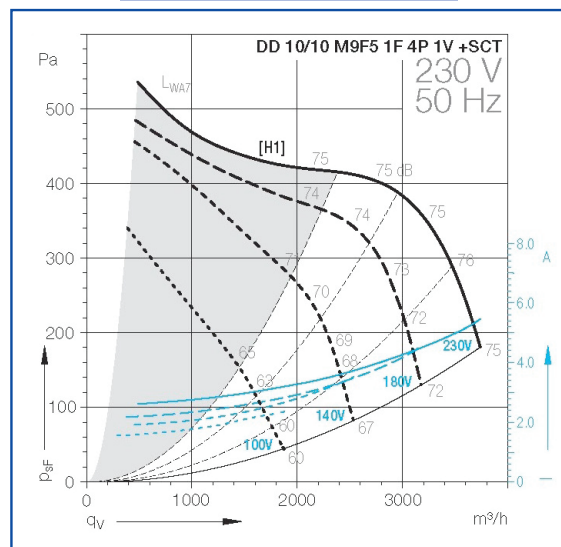

DD 9/9 245 6P-3V

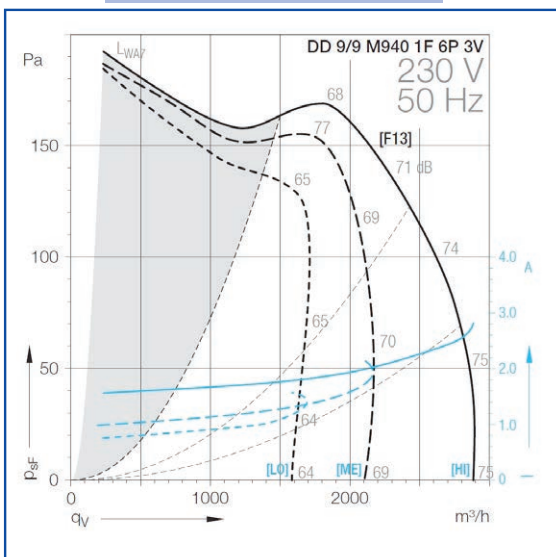

DD 10/8 245 6P-3V

